

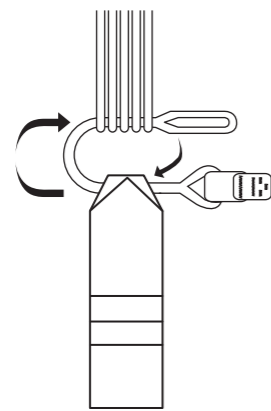

# Installation Instructions for Removable Softlinks SPORT

**NZ AEROSPORTS LTD**  
Level 1, 137 Great North Road  
Grey Lynn Auckland, New Zealand  
Phone: +64 9 360 0045  
info@nzaerosports.com  
[www.nzaerosports.com](http://www.nzaerosports.com)



**1.** Pass the softlink through the riser and the lines ensuring that you tuck the corners of the riser webbing in.

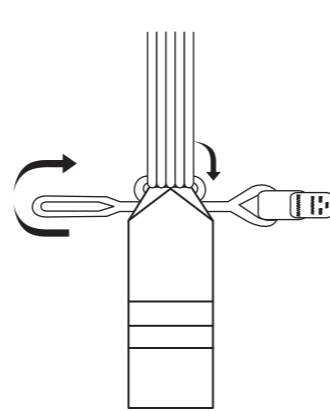

**2.** Pass the Softlink through the riser and line group a 2nd time.

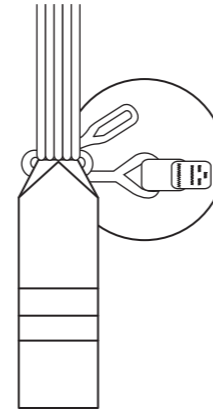

**3.** Both ends of the Softlink should exit on the same side.

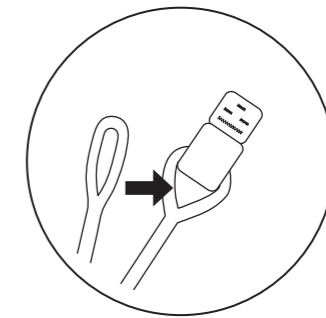

**4.** Pass the end through the opening under the tab.

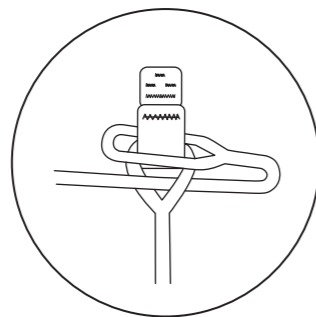
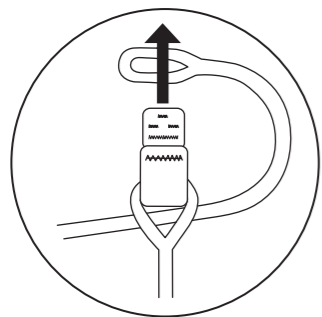

**5.** Feed the tab through the loop.

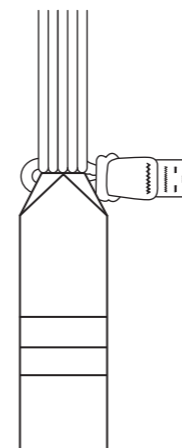
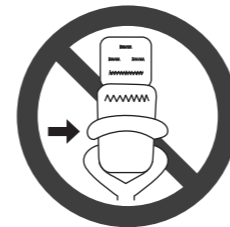
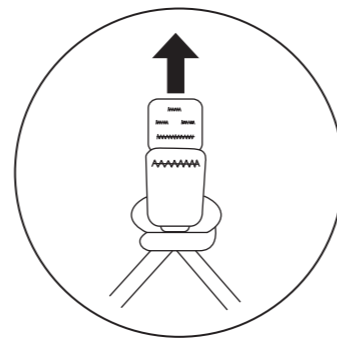

**6.** Pull the tab so that the loop tightens.

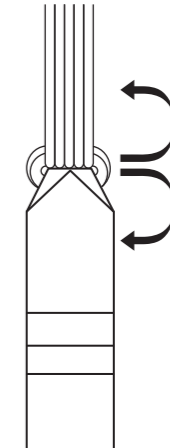

**7.** Grasp above and below the Softlink and pull to 20kg to set the link. Tuck the tab away inside the riser webbing opening.